

### CONTORE

Tipo: **CONTAHK46**



#### Highlights

- price competitive meter
- excellent quality
- long lifetime
- different bezels for different cut-outs
- many mounting versions
- all necessary approvals
- your branding available

#### Applications

- gen-sets
- compressors
- pumps
- medical equipment
- control panels
- air conditioning

#### Mechanical data

Front dimension: 48 x 48 mm

Display AC: 5 integers, 2 decimals  
DC: 6 integers, 1 decimal  
AC indicator, without reset

Digit height 4 mm

Digit color integer: white on black  
decimal: 50 Hz – red on black  
60 Hz – red on white

Counting range AC: 99999,99 h, DC: 999999,9 h

Reading accuracy AC: 1/100 h (36 sec)

DC: 1/10 h (6 min)

Weight ca. 50 g

Housing color standard black

Bezels 52x52  
55x55  
72x72 and Ø80 mm

Mounting options  
A - aluminum clamp  
C - anti-vibration boot & clamp  
D - DIN rail  
F - snap fastener  
G - retainer

#### Electrical data

Operating voltage 24, 48, 60, 110, 120, 220, 230, 240,  
400 VAC ± 10%, 50 or 60 Hz

Current consumption 6-30, 10-80, 110, 220 VDC ± 10%  
AC: max. 8 mA  
DC: max. 9 mA

Accuracy AC: ± 0,02 %  
DC: ± 0,002 %

Connection flat pin 6,3x0,8 with screw  
flat pin 6,3x0,8  
screw terminal

#### Ambient conditions

Operating temperature AC: -25° C .. +80° C

DC: -20° C .. +70° C

Storage temperature AC: -40° C .. +80° C

DC: -20° C .. +70° C

Relative humidity max. 80% at +25° C

Protection IP40 front  
IP65 front (on request)  
IP20 terminals

Approvals CE Mark  
UL E171200

RoHS compliant

#### Panel cut-outs

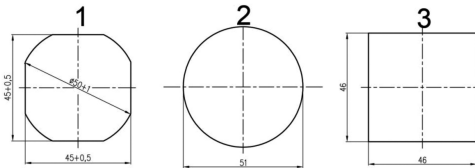

x (mm)	y (mm)	Mounting hole
48 x 48	6	1
52 x 52	8	1, 2 or 3
55 x 55	8	1, 2 or 3
72 x 72	8	1, 2 or 3

Cut-out #1: for meters with front dimensions 48x48 mm (without bezel)  
Cut-out #1,#2,#3: for meters with square 52, 55 and 72 mm bezels

